

CWT Manual Lab Guide

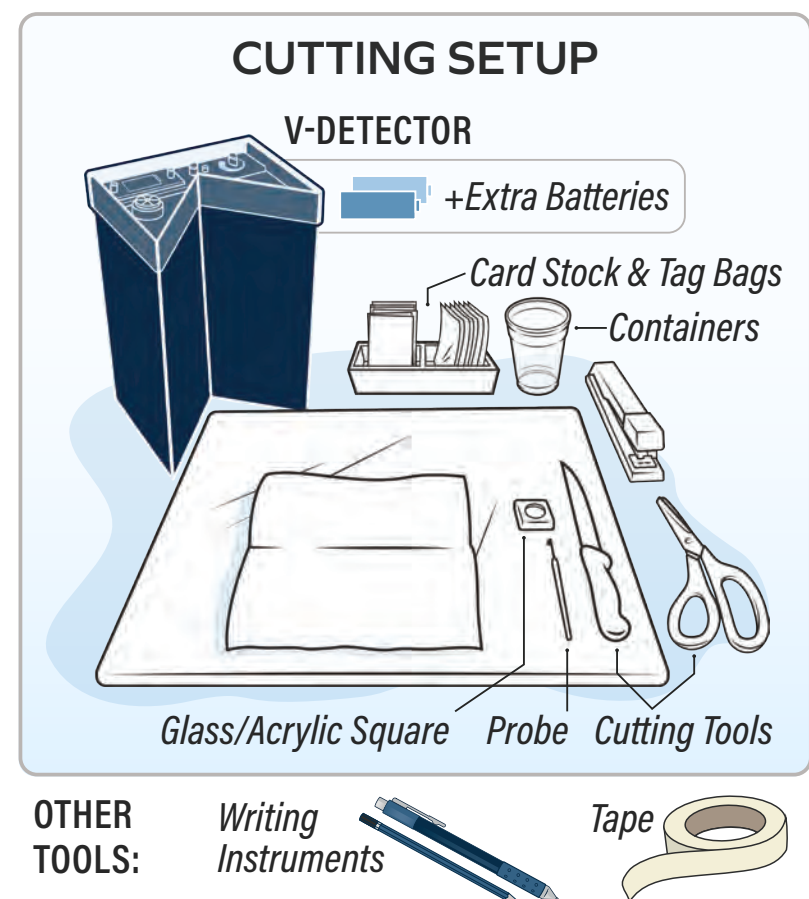

A **CODED WIRE TAG (CWT)** is a small piece of wire etched with a code and injected into snouts of juvenile salmon and steelhead

1 LAB STATION ESSENTIALS

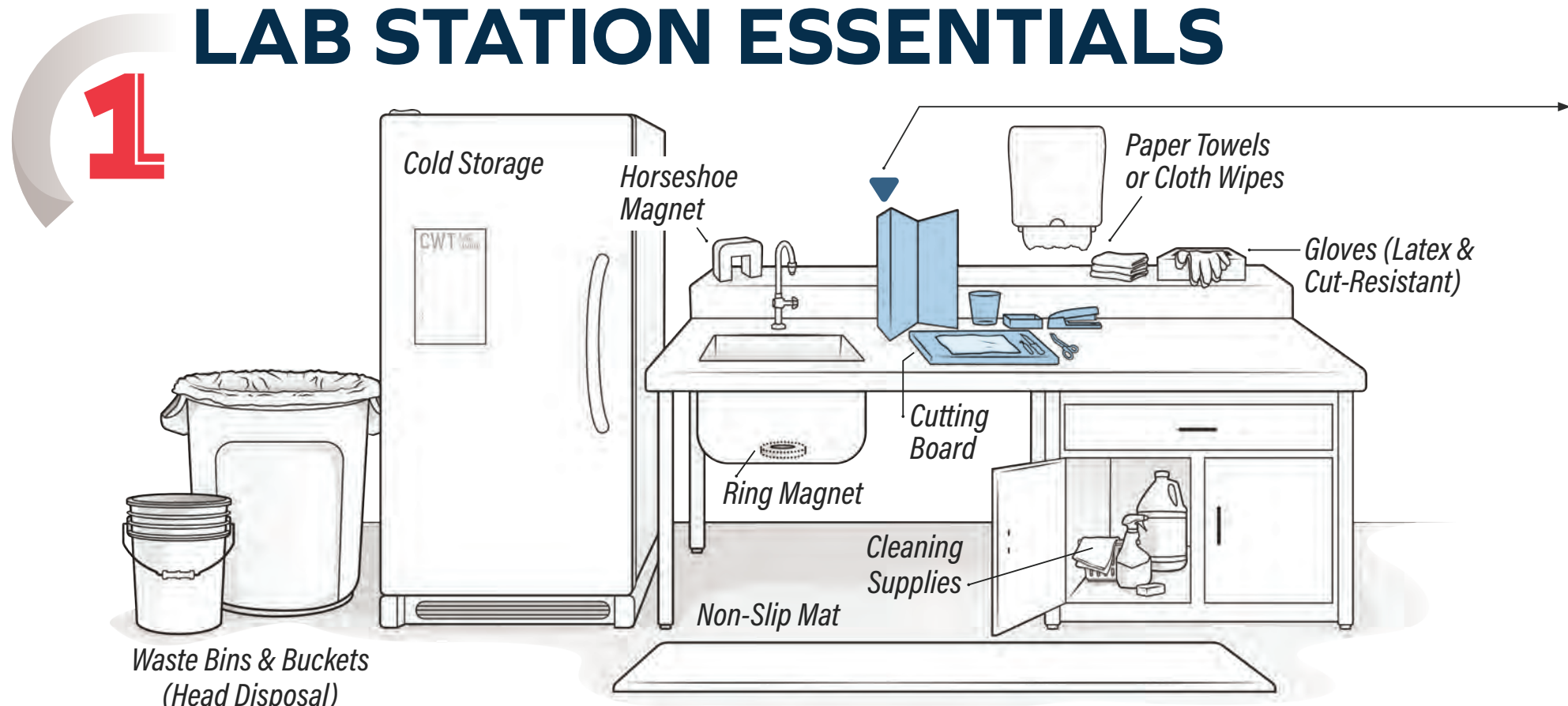

2 ISOLATE

[A] Thaw & clean head/snout

[B] Confirm presence of CWT with V-Detector

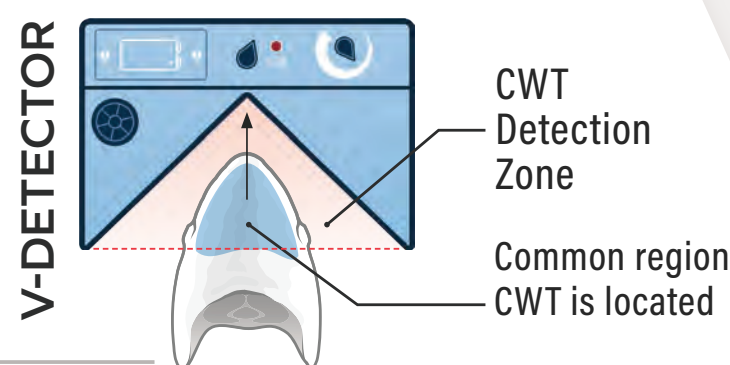

Always make cuts with tissue sample in most stable position

Only divide tissue that produces a signal

[C] Isolate CWT by cutting

1 Make series of cuts to reduce size of sample

2 Run tissue sample by V-detector to confirm CWT

3 Repeat cutting tissue in halves & scanning until CWT is isolated

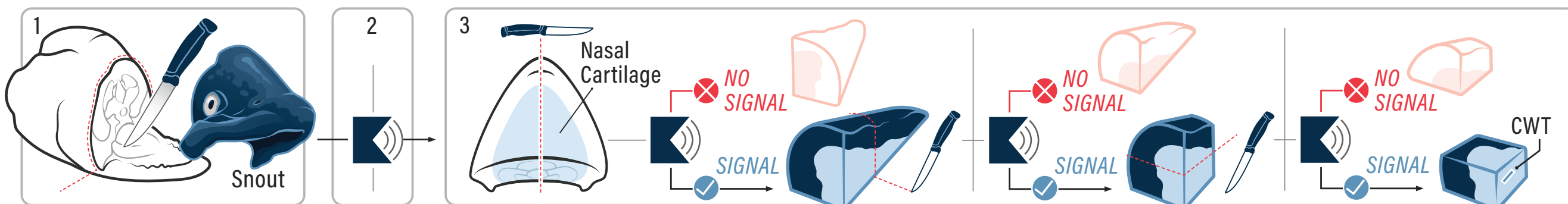

3 READ & RECORD

Identify CWT code and attach CWT to reading/recording sheet

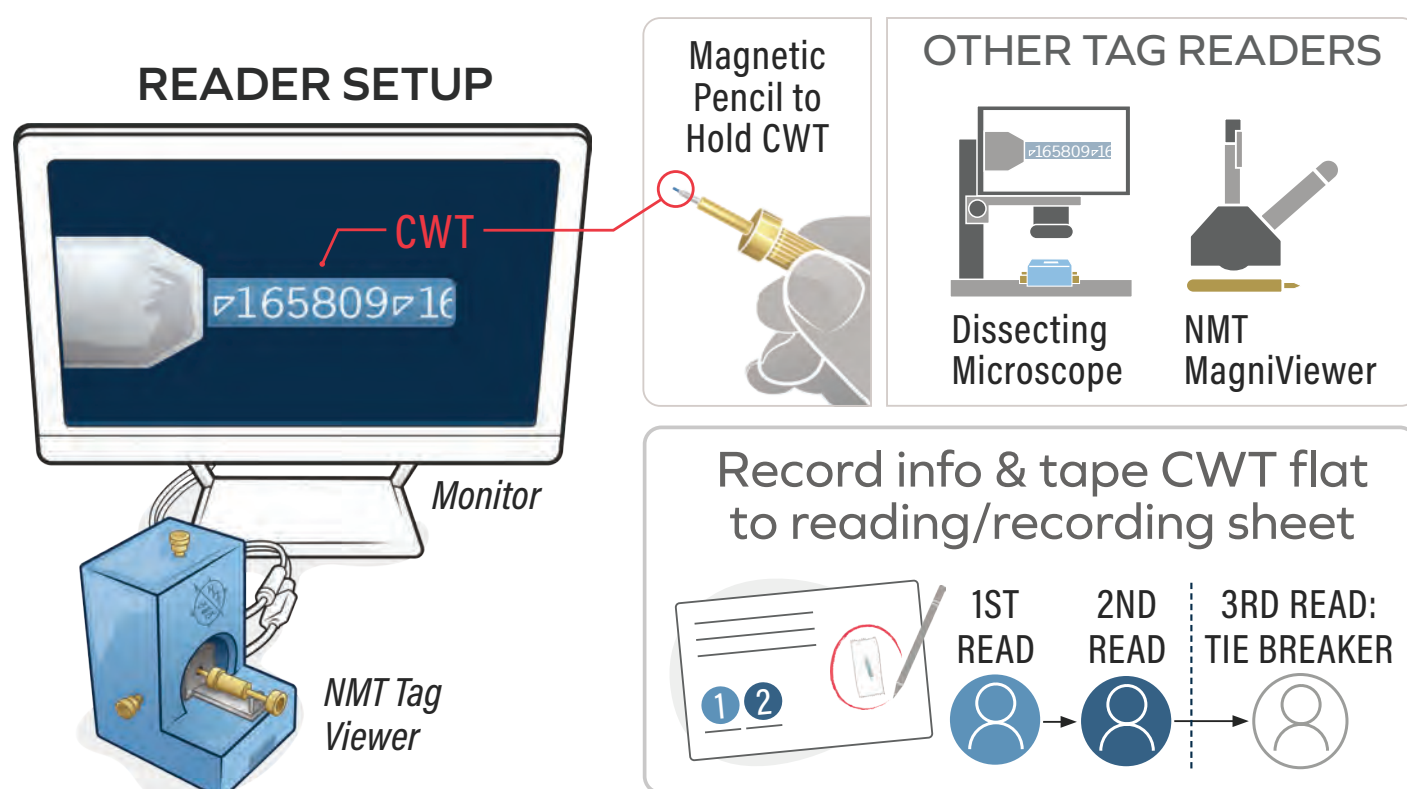

4 STORE

Sort and file reading/recording sheets with attached CWT

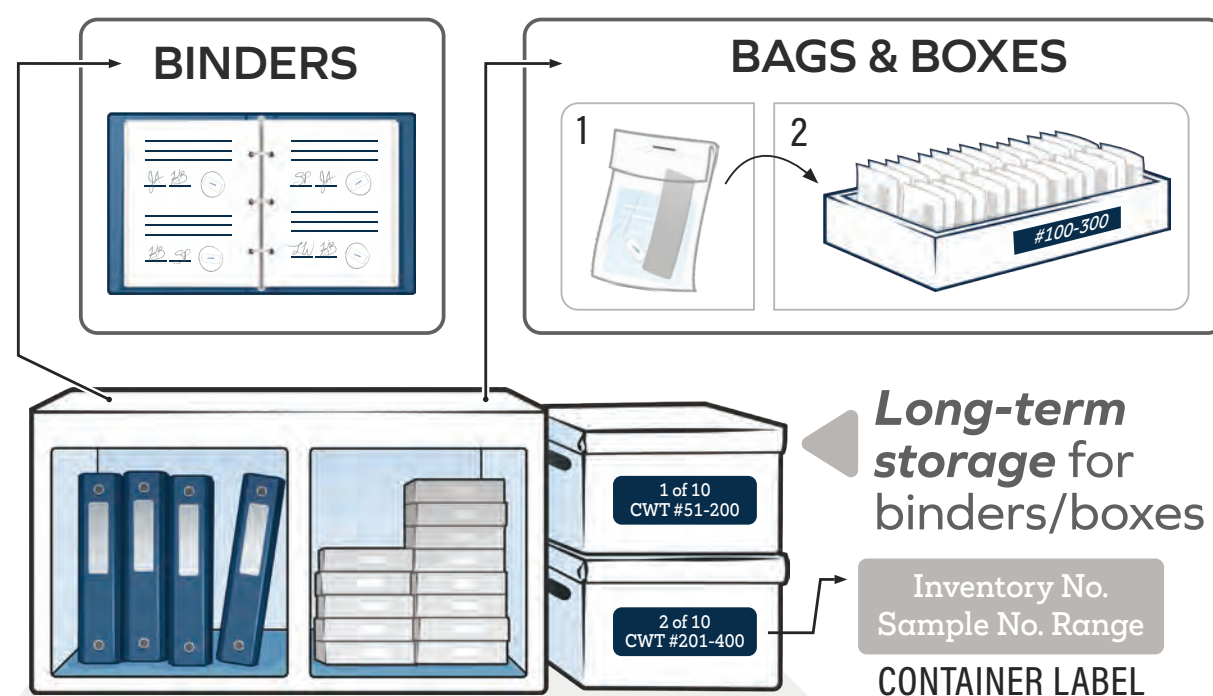

For more detail, scan code for
**CWT Recommended
Procedures Documents**

Pacific States Marine Fisheries Commission © 2024



Clean and organize
the lab workspace
before and after CWT
extraction.